

sherpa 60

ARCADIA
YACHTS



A RENAISSANCE OF SAILING

From a gulf that is an ancient cradle
of sailing traditions and culture,
from a land with a long tradition of hospitality.

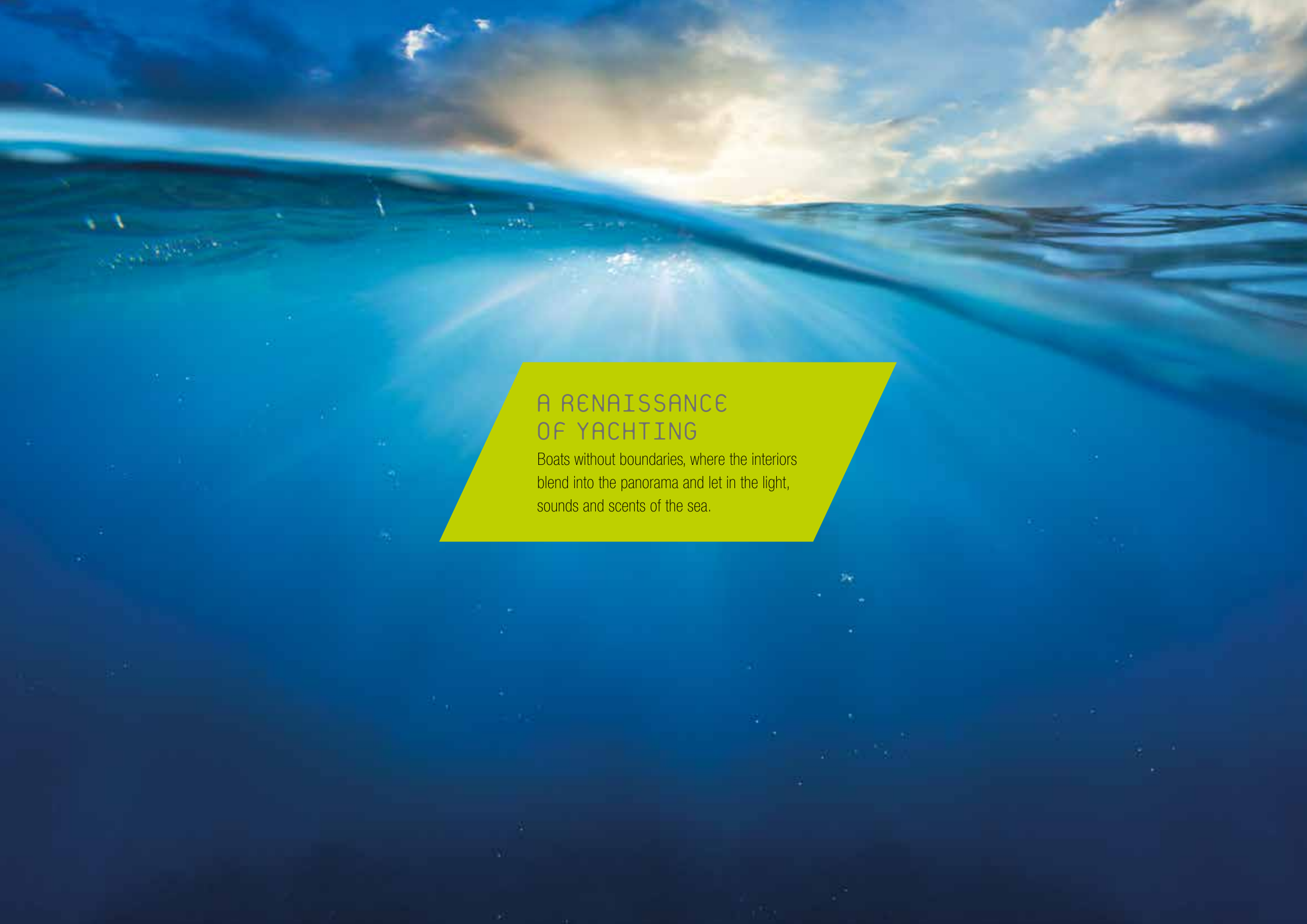

A RENAISSANCE OF YACHTING

Boats without boundaries, where the interiors
blend into the panorama and let in the light,
sounds and scents of the sea.



A RENAISSANCE OF TECHNOLOGY

More respect for nature, more comfort
living together, more sensitivity
to rediscover the sea.



A RENAISSANCE OF THE HUMAN BEING

In the midst of a new voyage,
on a course taking us farther than ever
before, surrounded by wonders.



OUR HERITAGE

ARCADIA YACHTS identifies with the values of a culture thousands of years old, a culture that has made its mark on history, art and architecture, characterised by a love of beauty and good taste and by the joy of sharing. From ancient Pompeii to the Maritime Republic of Amalfi, from the Neapolitan Renaissance to the city's traditional cuisine: ARCADIA YACHTS was founded in a place where the people cherish beauty.

sherpa 60

Delightful sailing and the peaceful roadstead:
an agile pocket-mega yacht offering yacht owners
unparalleled spaces to enjoy spending time together
and incomparable technological solutions.























TERRACE









CONVERTIBLE
SKY-LOUNGE



LOWER DECK

Master Quarter





Master Bathroom



Guest Cabin



Day Head

UNIQUE
FEATURES

50SQM AFT-DECK
FOR GETTING TOGETHER.



CONVERTIBLE SKY-LOUNGE

The Up&Down windows transform the sky-lounge into an open or covered deck according to the wishes of yacht owners and their guests.



SEMI-PLANING HULL AND IPS

The ARCADIA spirit enhances already existing synergies: the efficient, comfortable hull forms combine with the agile, high-performance innovative IPS propulsion system.



SOLAR PANELS

Approx. 25 sqm of state-of-the-art solar panels generate approximately 1.5 kW for the main appliances on board.



GARAGE

Approx. 23,000 L of stowage for tender, jet skis and much more.

GENERAL
ARRANGEMENTS
AND MAIN DATA



sherpa 60

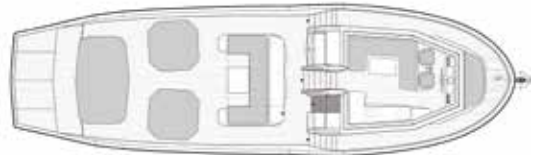

OPEN DECK
Standard version



OPEN DECK
Main optional available

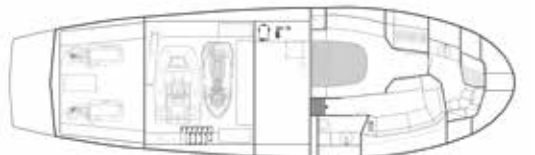

LOWER DECK
Suite version

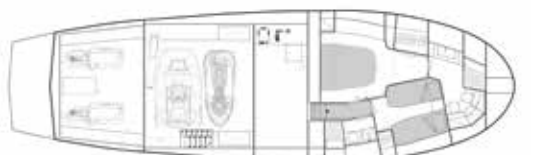

LOWER DECK
2 cabins version

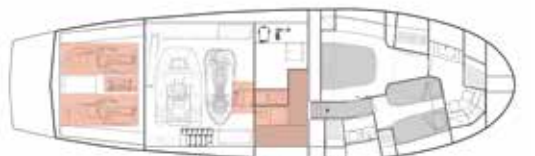

LOWER DECK
Main optional available



HULL	SEMI-PLANING
HULL & MAIN DECK CONSTRUCTION MATERIAL	FIBERGLASS
OVERALL LENGTH	18,67 mt / 61'03"
WATERLINE LENGHT	15,68 m / 51'05"
MAXIMUM BEAM	5,58 m / 18'04"
MAXIMUM DRAFT	1,32 / 4'04"
DISPLACEMENT UNDER FULL LOAD	33 tons / 72.752 lb
MAIN ENGINES	2x VOLVO PENTA IPS 600 (std) / 700 / 800
MAXIMUM SPEED	±19,5 (std) / ±21 (opt IPS 700) / ±22 kn (opt IPS 800)
CRUISE SPEED	±16 (std) / ±18 (opt IPS 700) / ±19 kn (opt IPS 800)
GENERATOR (MED / TROPICAL version)	16.0 kW - 50/60 Hz
BOILER	N.1 50 l / 13 gal
AIR CONDITIONING (MED / TROPICAL version)	50.000 Btu/h / 70.000 Btu/h
ELECTROHYDRAULIC TENDER DAVIT	400 kg / 882 lb
ELECTROHYDRAULIC MULTIFUNCTION GANGWAY	1,70 m - 120 kg / 5'07" - 265 lb
SOLAR PANELS ENERGY	±3.4 kW
GUEST BEDS	4 / 2
CREW BED	2 (OPTIONAL)
TANKS CAPACITY	
FUEL	3.400 l - 900 gal
WATER	730 l - 192 gal
GREY WATER	210 l - 56 gal
SEWAGE	180 l - 48 gal

OUR FLEET ARCHITECTURE

Our fleet has evolved in response to the highly various needs of experienced yacht owners and sailors to include vessels ranging from 18 to 35 metres, divided into two series, each with its own unique personality. A Renaissance on board, a new way to feel the sea.



sherpa 80

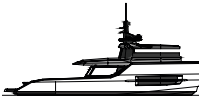

sherpa 60

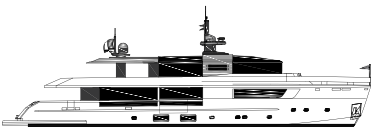

A115



A105



A96

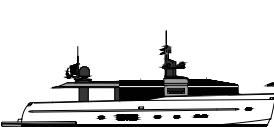

A85

sherpa
THE POCKET-SIZED MEGA YACHT

Comfortable, agile, with options for customisation and expansive open spaces.

A
THE SYNTHESIS OF A PARADOX

The thin boundary between inside and outside, between sociability and privacy.

Tender and toys are not included in standard configuration and price.
The information contained in this data sheet are not binding. For updated materials, please contact the shipyard or your official rep.

Optional features available



OUR SHIPYARD

Every renaissance begins in a specific location.

The ARCADIA YACHTS renaissance begins in its shipyard, the centre of Arcadia's design and shipbuilding work, where it all happens: from the lamination of hulls and fibreglass to woodworking and finishing. An advanced, energy-efficient facility extending over a 36,000 sqm area in the Gulf of Sorrento, a renowned centre of shipbuilding. Since ever.



What really counts at sea
is knowing where you are
and which direction
you are heading in:
ARCADIA YACHTS has set its course
for the future, with the sailors
of today and tomorrow.

A115



A105



A96



A85



sherpa 60



sherpa 80



ARCADIA AWARDS



WORLD YACHTS TROPHIES
A85
WINNER 2010
Yacht with interior and exterior design
and innovative technologies



MOTOR BOAT AND MOTOR BOATS
MONTHLY MAGAZINE
A85
WINNER 2011
Best Custom Yacht



ADI - INDUSTRIAL DESIGN
ASSOCIATION NAUTICAL DESIGN AWARD
A85
WINNER 2011
Best motoryacht interior design



ROBB REPORT MAGAZINE
A85
WINNER 2012
Best of the Best Motoryacht



WORLD YACHTS TROPHIES
A115
WINNER 2012
Yacht with best interior layout



CHAMPION JACHTINGU
sherpa 60
WINNER 2016
Most promising premier Yacht



WORLD YACHTS TROPHIES
sherpa 60
WINNER 2016
Most innovative Yacht 50'-80'



VELA&MOTORE MAGAZINE
sherpa 60
WINNER 2016
Yacht of the year



WORLD YACHTS TROPHIES
A105
WINNER 2018
Most innovative Yacht



WORLD YACHTS TROPHIES
sherpa 80xL
WINNER 2019
Best innovation 64-80'



THE WORLD SUPERYACHT
A105
WINNER 2019
Best Motor Yacht



THE WORLD SUPERYACHT
A105
NOMINEE 2020
Best Motor Yacht



ADI DESIGN INDEX
sherpa 80xL
SELECTION 2020
Mobility Category



WORLD YACHTS TROPHIES
A96
WINNER 2023
Most innovative Yacht



DESIGN & INNOVATION AWARDS
A96
FINALIST 2024
Best Interior Design



DESIGN & INNOVATION AWARDS
A96
FINALIST 2024
Eco Award

This brochure in no way constitutes a contract of sale for the boatyard's vessels to any person or company.
All information contained herein, including but not limited to technical and performance data, illustrations, and drawings, is non-binding and for purposes of illustration only.
The information in this brochure refers to the boatyard's standard motoryacht models available as of the date of publication.
Technical and descriptive information is valid only to the extent that it pertains to the specific vessel that is the subject of a purchase.

Contract terms are valid only to the extent that they are contained in a contract of sale.
This document is based on information available at the time of publication.
Despite efforts to ensure the greatest possible accuracy, the information contained herein may fail to cover all details, omit technical or commercial changes that may have been made subsequent to publication, describe features that are not present, and fail to envisage all circumstances that might occur.
Any illustrations, photographs, diagrams and examples shown in this brochure are included solely for the purposes of illustrating the text.
Due to the different features of each vessel, the boatyard assumes no liability for actual use based on the illustrated applications.

